

SA's Leading Past Year

Exam Paper Portal



You have Downloaded, yet Another Great  
Resource to assist you with your Studies 😊

Thank You for Supporting SA Exam Papers

Your Leading Past Year Exam Paper Resource Portal

Visit us @ [www.saexampapers.co.za](http://www.saexampapers.co.za)



SA EXAM  
PAPERS



# basic education

Department:  
Basic Education  
**REPUBLIC OF SOUTH AFRICA**

## NATIONAL SENIOR CERTIFICATE

**GRADE 12**

**GEOGRAPHY P2**

**NOVEMBER 2017**

**MARKS: 75**

**TIME: 1½ hours**

<b>EXAMINATION NUMBER:</b>														
<b>CENTRE NUMBER:</b>														

	M	In	SM	In	DM	In	CM	In	IM	In	MC	EA	EX	RM	In
Q1															
Q2															
Q3															
Q4															
TOT															

**This question paper consists of 15 pages and  
1 page for rough work and calculations.**

**RESOURCE MATERIAL**

1. An extract from topographical map 2627CD PARYS
2. Orthophoto map 2627 CD 19 PARYS
3. **NOTE:** The resource material must be collected by schools for their own use.

**INSTRUCTIONS AND INFORMATION**

1. Write your EXAMINATION NUMBER and CENTRE NUMBER in the spaces on the cover page.
2. Answer ALL the questions in the spaces provided in this question paper.
3. You are provided with a 1 : 50 000 topographical map (2627CD PARYS) and an orthophoto map (2627 CD 19 PARYS) of a part of the mapped area.
4. You must hand the topographical map and the orthophoto map to the invigilator at the end of this examination session.
5. You may use the blank page at the back of this question paper for all rough work and calculations. Do NOT detach this page from the question paper.
6. Show ALL calculations and use supplied formulae, where applicable. Marks will be allocated for these.
7. Indicate the correct unit of measurement in the final answer of calculations. NO marks will be allocated for answers with incorrect units.
8. You may use a non-programmable calculator and a magnifying glass.
9. The area demarcated in RED on the topographical map represents the area covered by the orthophoto map.
10. The following English terms and their Afrikaans translations are shown on the topographical map:

**ENGLISH**

Aerodrome  
Caravan Park  
Diggings  
Golf Course  
Gap  
Holiday Resort  
Island  
Purification Plant  
River  
Sewage Works

**AFRIKAANS**

Vliegveld  
Karavaanpark  
Uitgrawings  
Gholfbaan  
Poort  
Vakansieoord  
Eiland  
Watersuiweringsaanleg  
Rivier  
Rioolwerke

**GENERAL INFORMATION ON PARYS**

Parys is a town in the Free State in South Africa. It is located on the banks of the Vaal River approximately 115 km south of Johannesburg. The completion of the railway line to Parys in 1905 suddenly made Parys more accessible to the public and this, in turn, led to the growth of the town as a holiday resort and industrial centre. Many artists have settled in the town and the variety of new, interesting shops and attractions make it the ideal breakaway from Gauteng and other big centres. Parys lies within the Vredefort Dome World Heritage Site. The Vredefort Crater is the largest verified impact crater on Earth. The Vredefort Dome was added to the list of UNESCO World Heritage Sites for its geological interest.



Coordinates: 26°54'S 27°27'E

[Adapted from [http://en.wikipedia.org/wiki/Parys, South Africa, Freestate](http://en.wikipedia.org/wiki/Parys,_South_Africa,_Freestate)]

**QUESTION 1: MULTIPLE-CHOICE QUESTIONS**

The questions below are based on the 1 : 50 000 topographical map (2627CD PARYS), as well as the orthophoto map of a part of the mapped area. Various options are provided as possible answers to the following questions. Choose the answer and write only the letter (A–D) in the block next to each question.

1.1 The major industrial region closest to Parys is the ... industrial region.

- A Port Elizabeth-Uitenhage
- B Durban-Pinetown
- C Western Cape
- D Pretoria-Witwatersrand-Vereeniging

1.2 The topographical map northwest of Parys is situated between the following lines of latitude:

- A 27°00'S and 27°15'S
- B 26°30'S and 26°45'S
- C 26°00'S and 27°00'S
- D 26°15'S and 26°30'S

1.3 The height of the index contour line in block **D5** is ... metres.

- A 1 500
- B 1 400
- C 1 600
- D 1 530

1.4 A human factor limiting further expansion of Parys in a north-westerly direction is the ...

- A permanent river.
- B international boundary.
- C provincial boundary.
- D steep gradient.

1.5 The windpump **K** in block **I2** is situated next to the river, because this area has a ... water table.

- A high dry season
- B high wet season
- C low dry season
- D low wet season

1.6 The feature at 26°49'48"S 27°21'54"E/26°49,8'S 27°21,9'E:

- A Hiking trail
- B Perennial water
- C Cultivated land
- D Secondary road

☐

1.7 The location of the woodlands in block **B9** was influenced by the ...

- A katabatic flow.
- B anabatic flow.
- C thermal belt.
- D aspect of slope.

☐

1.8 The section of the Vaal River in the mapped area shows characteristics typical of the ...

- A middle and lower courses.
- B upper course only.
- C upper and lower courses.
- D lower course only.

☐

1.9 The landform at line **4** on the orthophoto map is a ...

- A spur.
- B valley.
- C ridge.
- D gap.

☐

1.10 The plots of land in block **F9** have elongated (long and narrow) shapes. The most important reason for this shape is to have access to (the) ...

- A water.
- B fertile soil.
- C flat land.
- D fuel.

☐

1.11 The road at **3** on the orthophoto map is ...

- A another road.
- B an arterial route.
- C a secondary road.
- D a main road.

☐

1.12 The cultivated land at **5** on the orthophoto map can be identified by its ...

- A darker tone.
- B smooth texture.
- C shadow.
- D shape.

☐

1.13 Refer to the surrounding area at **15** on the orthophoto map. The vertical aerial photograph used to produce the orthophoto map was taken between ...

- A 12:00 and 14:00.
- B 14:00 and 16:00.
- C 10:00 and 12:00.
- D 08:00 and 10:00.

☐

1.14 The settlement pattern at **L** in block **D2** is ...

- A circular.
- B linear.
- C clustered.
- D dispersed.

☐

1.15 The natural water purification feature in blocks **J2** and **J3** is a ...

- A windpump.
- B cultivated land.
- C marsh and vlei.
- D excavation.

☐

(15 x 1)

**[15]**

**QUESTION 2: MAP CALCULATIONS AND TECHNIQUES**

2.1 Refer to blocks **D3** and **E3**.

2.1.1 Calculate the vertical interval (VI) between **M** and spot height 1 395 in metres. Show ALL calculations. Marks will be awarded for calculations.

---

---

---

---

(1 x 1) (1)

2.1.2 Calculate the horizontal equivalent (HE) between **M** and spot height 1 395 in metres. Show ALL calculations. Marks will be awarded for calculations.

---

---

---

---

---

(2 x 1) (2)

2.1.3 Using the information in QUESTIONS 2.1.1 and 2.1.2, calculate the average gradient between **M** and spot height 1 395. Show ALL calculations. Marks will be awarded for calculations.

Formula: **Gradient** =  $\frac{\text{vertical interval (VI)}}{\text{horizontal equivalent (HE)}}$

---

---

---

---

---

(2 x 1) (2)

- 2.1.4 Would the gradient calculated in QUESTION 2.1.3 result in a low or high stream velocity? Give a reason for your answer.

Answer: \_\_\_\_\_

Reason: \_\_\_\_\_

\_\_\_\_\_

\_\_\_\_\_

(2 x 1)

(2)

- 2.2 Refer to line 6 to 7 on the orthophoto map.

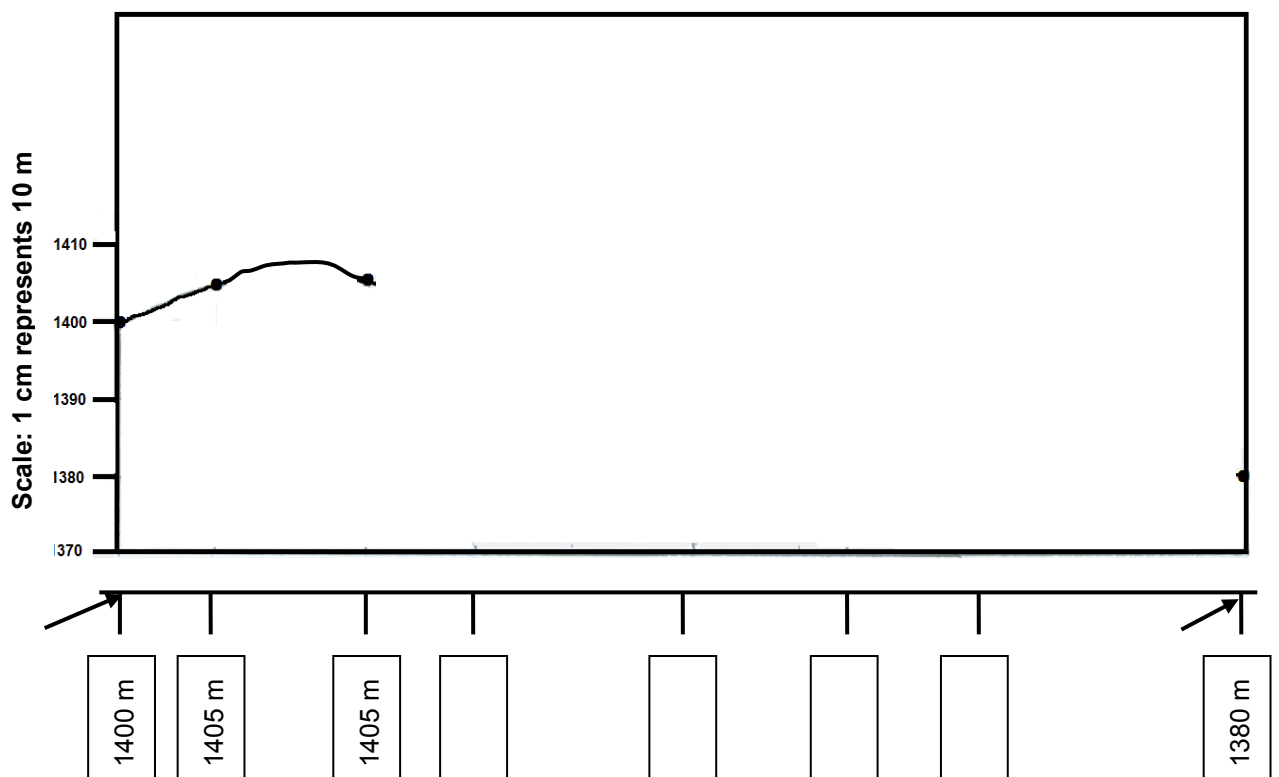

- 2.2.1 Use the marked-off points below the horizontal axis of the cross-section to complete the cross-section between 6 and 7 above. Some heights have been included to assist you. (4 x 1) (4)
- 2.2.2 Indicate the position of the Pelgrimsrus farmstead on the completed cross-section in QUESTION 2.2.1. (1 x 1) (1)

- 2.2.3 Calculate the vertical exaggeration of the cross-section drawn in QUESTION 2.2.1. Show ALL calculations. Marks will be awarded for calculations.

Formula: **Vertical exaggeration** =  $\frac{\text{vertical scale (VS)}}{\text{horizontal scale (HS)}}$

---

---

---

---

---

---

(4 x 1) (4)

- 2.3 Refer to the orthophoto map and the topographical map.

- 2.3.1 The magnetic declination of the orthophoto map for 1980 is given as 17°50' west of True North. Is the magnetic declination of the orthophoto map bigger or smaller than the magnetic declination indicated on the topographical map?

---

(1 x 1) (1)

- 2.3.2 Give a reason for the difference in the magnetic declination between the topographical map and the orthophoto map.

---

---

(2 x 1) (2)

- 2.3.3 Why is it important for a hiker to correct the magnetic declination?

---

---

(1 x 1) (1)  
[20]

**QUESTION 3: APPLICATION AND INTERPRETATION**

3.1 Refer to blocks **E4** and **F3**.

3.1.1 Name the drainage pattern in this area.

\_\_\_\_\_ (1 x 1) (1)

3.1.2 Refer to the topographical map and explain why the drainage pattern named in QUESTION 3.1.1 developed.

\_\_\_\_\_  
\_\_\_\_\_  
\_\_\_\_\_ (1 x 2) (2)

3.1.3 Is the drainage density of this area high or low? Give ONE reason for your answer.

Drainage density: \_\_\_\_\_

Reason: \_\_\_\_\_

\_\_\_\_\_  
\_\_\_\_\_

\_\_\_\_\_ (1 + 2) (3)

3.2 Refer to the farmstead at **O** in block **G2**.

3.2.1 Is the farmstead at **O** a wet-point settlement or a dry-point settlement? Give a reason for your answer.

Answer: \_\_\_\_\_

Reason: \_\_\_\_\_

\_\_\_\_\_

\_\_\_\_\_ (1 + 2) (3)

- 3.2.2 Name and explain ONE human-made factor that influenced the choice of site for the farmstead.

Human-made factor: \_\_\_\_\_

Explanation: \_\_\_\_\_

\_\_\_\_\_

\_\_\_\_\_ (1 + 2)

(3)

- 3.3 Refer to blocks **G9** and **G10**, which is the rural-urban fringe of Parys.

- 3.3.1 Name ONE activity/service in block **G9** and/or block **G10** that is found in the rural-urban fringe.

\_\_\_\_\_ (1 x 1)

(1)

- 3.3.2 Explain why the activity/service named in QUESTION 3.3.1 is located in the rural-urban fringe.

\_\_\_\_\_

\_\_\_\_\_

\_\_\_\_\_ (1 x 2)

(2)

- 3.4 Although West End (**W**) in block **H7** is situated close to the CBD, it experiences much lower average temperatures than expected.

- 3.4.1 Give and explain ONE reason for the statement above.

Reason: \_\_\_\_\_

Explanation: \_\_\_\_\_

\_\_\_\_\_

\_\_\_\_\_ (1 + 2)

(3)

- 3.4.2 Describe ONE climatological disadvantage for people living in West End.

\_\_\_\_\_

\_\_\_\_\_

\_\_\_\_\_ (1 x 2)

(2)

- 3.5 The mapped area receives seasonal rainfall. Give TWO points of evidence in the topographical map to substantiate (support) this statement.

---

---

---

---

(2 x 1) (2)

- 3.6 Parys is a popular holiday resort.

- 3.6.1 Give ONE reason why Parys became a popular holiday destination.

---

---

(1 x 1) (1)

- 3.6.2 Explain the positive impact of Parys as a popular holiday destination on the local economy.

---

---

---

(1 x 2) (2)  
**[25]**

**QUESTION 4: GEOGRAPHICAL INFORMATION SYSTEMS (GIS)**

4.1 Parys is located in the Vredefort Crater. Geologists are conducting research and collecting data on an on-going basis.

4.1.1 Is the data that is collected considered to be primary or secondary data?

\_\_\_\_\_ (1 x 1) (1)

4.1.2 Give a reason for your answer to QUESTION 4.1.1.

\_\_\_\_\_  
\_\_\_\_\_  
\_\_\_\_\_ (1 x 2) (2)

4.1.3 Explain how remote sensing can further assist the geologists with their research.

\_\_\_\_\_  
\_\_\_\_\_  
\_\_\_\_\_  
\_\_\_\_\_ (2 x 2) (4)

4.2 Refer to block **J8**. Buffering plays an important role in protecting settlements from being flooded.

4.2.1 Define the term *buffering*.

\_\_\_\_\_  
\_\_\_\_\_ (1 x 1) (1)

4.2.2 There is no evidence of buffering taking place between the Vaal River and Parys in blocks **G7** and **G8**. Give a reason from the topographical map to support this statement.

\_\_\_\_\_  
\_\_\_\_\_ (1 x 2) (2)

- 4.2.3 Explain why no buffering takes place between the Vaal River and Parys in blocks **G7** and **G8**.

---

---

---

(1 x 2) (2)

- 4.3 Refer to the rough sketch below, an exaggerated version of block **F8**.  
(The examiner's sketch of block **F8** is not drawn to scale).

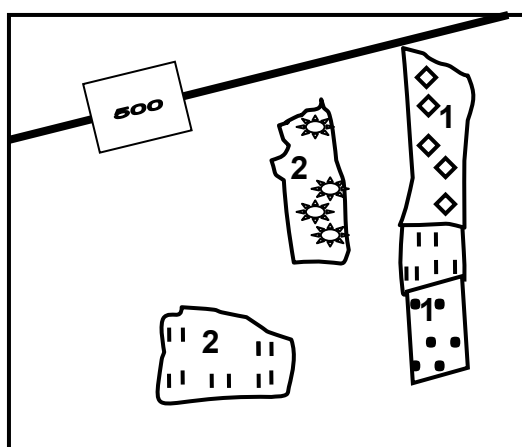

**Reference:**

- 1 – Orchards and vineyards  
2 – Cultivated lands

- 4.3.1 NO data standardisation is taking place in the sketch.

Give a reason to substantiate (support) this statement.

---

---

(1 x 1) (1)

- 4.3.2 Standardise the data in the sketch below, using the acceptable standardised conventional signs (map symbols) for a 1 : 50 000 topographical map.

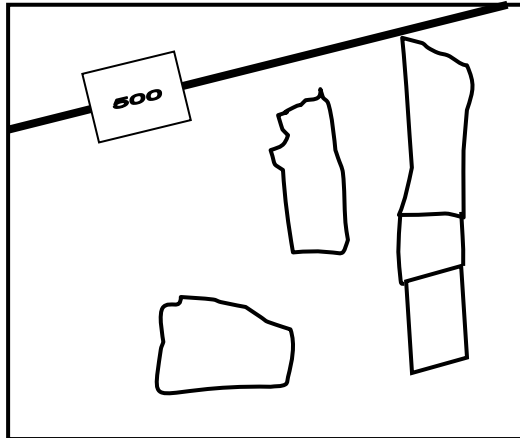

(2 x 1)

(2)  
[15]**TOTAL:****75**

**ROUGH WORK AND CALCULATIONS**

**(NOTE: Do NOT detach this page from the question paper.)**